

GUIDE TO APPLICATION OF WAXED CONCRETE COATING COUNTER, FLOOR AND SHOWER

01 Before application

+ Receipt of order

Mix the powder to distribute the pigments evenly.

+ Surface preparation

Your surface must be prepared in accordance with the instructions provided in the Silex élément smooth finish polished concrete application guide: smooth, dust-free, sound and degreased.

+ Surface protection

- Before each coat: apply painter's tape to the outer edges of the surface.
- After each coat: remove the tape while the mortar is still wet.

+ Mixing the coating and the adjuvant:

To make the mixture: 20% adjuvant to 80% powder.

- Make small quantities at a time (4 kg of powder maximum).
- Mix until you get a smooth paste that holds well on the trowel (without lumps and smooth). Depending on the desired consistency, add more adjuvant.



02 First layer

*Layer thickness: at least 1 mm (1/25").

+ Techniques d'application

- Use the joint knife to place the mortar on the trowel.
- To make thin layers, tilt your trowel at a 20° angle.
- To create random decorative effects, use crisscrossing semi-circular motions.

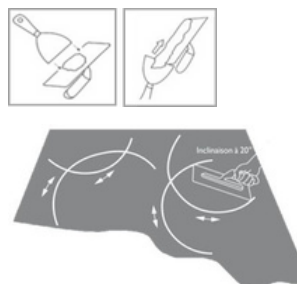

- + As soon as the coating begins to set*, remove the excess and even out the application with a dry sponge.

**Your handprint should no longer leave a mark, but the concrete should still be fresh enough to be smoothed.*

- + **Drying time:** at least 1 hour to the touch, and 4 hours to recoat. Drying can be accelerated using a fan.



03 Second layer

+ Techniques d'application :

- To make thin layers, tilt your trowel at a 30° angle.
- To create random decorative effects, use crisscrossing semi-circular motions.
- Put some pressure on.

**For a darker application, press down on the trowel, crushing the finish to smooth it out.*



+ **Drying time:** minimum 1 hour to the touch and 4 hours for applying the sealant.

04 Sanding the surface

+ **Sand with:** a 120 grit and then a 220 grit.

+ **Dusting:** a vacuum cleaner and with a slightly damp cloth.



05 Application of Silex Sealant

+ Techniques d'application:

- Pour the Silex Sealant into a paint tray.
- Start at the corners and edges with the brush.
- Apply the sealer to the entire surface in a thin layer using a stain pad. Do not leave any excess. Be careful with the foam roller as it can leave marks.

Work the sealant in well to saturate all pores on the surface.

+ **Drying time:** 6 hours minimum.

+ **Repeat application for a second coat.**

+ **Drying time:** 24 hours.



06 Application of Urethane Varnish

+ Techniques d'application:

- Mix the mixture in the correct proportions (5 A to 1 B). The varnish has a pot life of 30 minutes*.
- Apply a first coat of Silex urethane using a lint-free velvet roller.

+ **Drying time:** 12 hours minimum between each coat.

+ **Repeat application for a second coat.**

+ **Drying time:** 24 hours minimum

**Once mixed, the varnish is no longer recoverable after this time.*

+ **Advice :** The container used to make the mixture must be clean and dry.
Liquid B must never come into contact with any liquid other than A.

HEALTH AND SAFETY

It is recommended to wear gloves, protective glasses and a mask when applying and handling the products.

FIRST AID

It contains Portland cement and sand (crystalline silica).

- *If in EYES: Flush eyes with plenty of water for at least 15 minutes.*
- *If on SKIN: Wash exposed and/or contaminated areas thoroughly after handling.*
- *IF INHALIZED: Remove conscious victim to fresh air.*
- *IF SWALLOWED: Rinse mouth. Do NOT induce vomiting. Call a poison control center or doctor immediately.*

GUARANTEE

Silex element certifies that the product is free from any manufacturing defect upon leaving the factory. The user assumes full responsibility for the results of an application in accordance with the instructions on this label. The manufacturer's liability is limited to replacing the product.

RESPONSIBILITY

It is the user's responsibility to read the instructions for use before using the product. Visit our website at www.silexelement.com or download the guide:



**For further information, refer to the complete application guide for Silex Élément smooth finish polished concrete coating.*

*****KEEP OUT OF REACH OF CHILDREN*****

